



TOUCHKEY

TOUCHKEY AUTO-FIRE LOCK
INSTALLATION GUIDE

ERA

PREPARATION DETAIL

±2.20
THIS HOLE IS ON
INTERNAL SIDE ONLY.

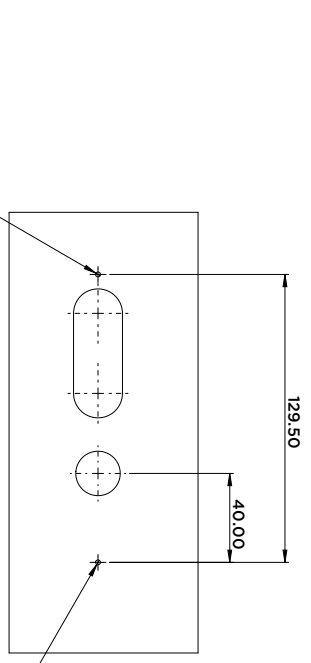

±2.20
THIS HOLES ON INTERNAL SIDE ONLY.
DEPTH OF 10mm

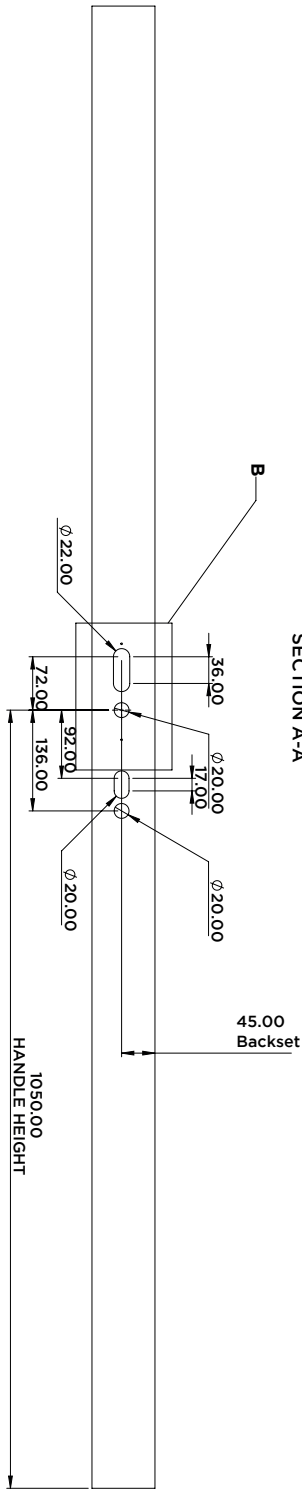

BOTTOM OF DOOR

SECTION A-A

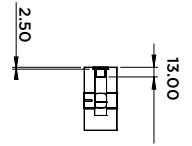
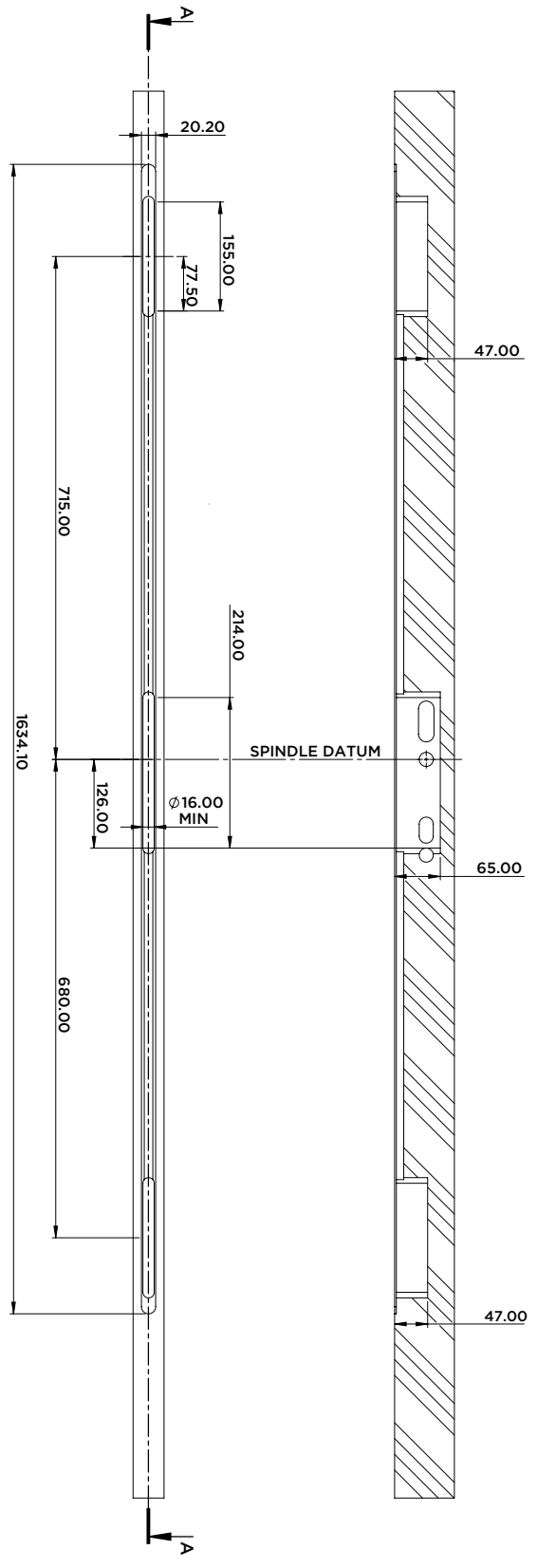

Not to scale. All dimensions are in mm and are nominal. ERA reserves the right to change specification without notice. It is the responsibility of the door manufacturer to ensure that the finished product meets any required safety and performance specification.

MPL LOCK PREPARATION

1.

Insert the multipoint lock into the prepared door and fasten with appropriate screws.

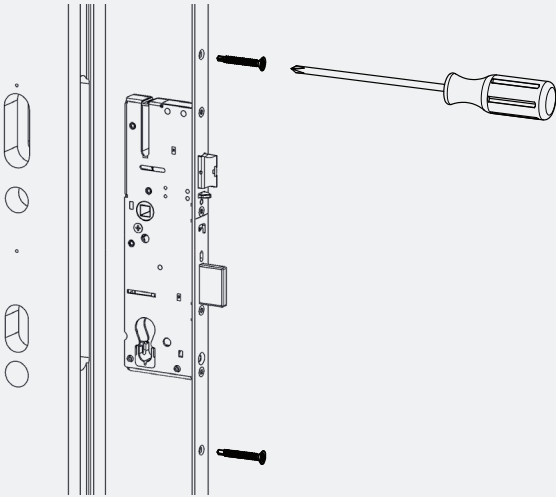

2.

Set latches to left or right handed by pulling the latch outwards and twisting to the correct position.

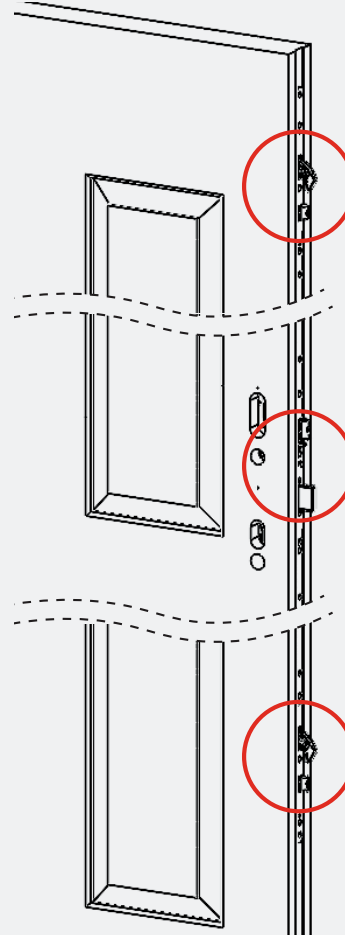

Please note: This is required for the top, centre and bottom latches.

3.

Fit the cylinder and check function of the lock (as per steps **a - c** below):

- Turn the thumbturn, check all hooks and the centre deadbolt retract.
- Return the cylinder to the normal position.
- Press the trigger on the centre gearbox to fire the hooks and centre deadbolt.

Please separate installation instructions for the TouchKey door handle and cylinder. We recommend these are fitted on site during door installation.

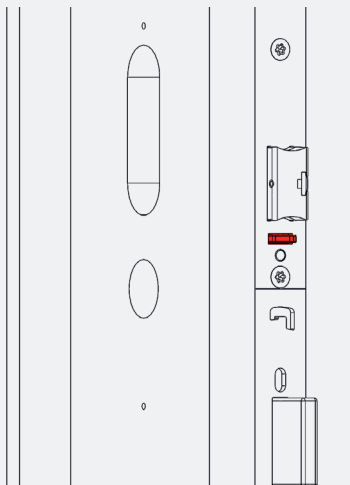

4.

You may choose to fit the handle mounting bracket prior to the door reaching the site.

If so, please remove the mounting bracket from the handle box (situated underneath the external handle in the holding pocket) and using the two fixing screws (in the handle box) secure the plate onto the internal face of the door, in the highlighted holes.

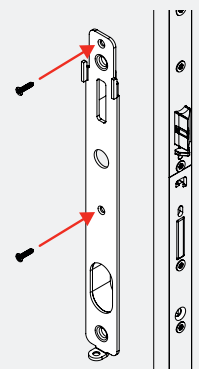

KEEP PREPARATION

1.

- a. Create routing required for the keep - use the routing jig provided if necessary (available on request).
- b. Centre line on the routing jig needs to be lined up with centre of latches.

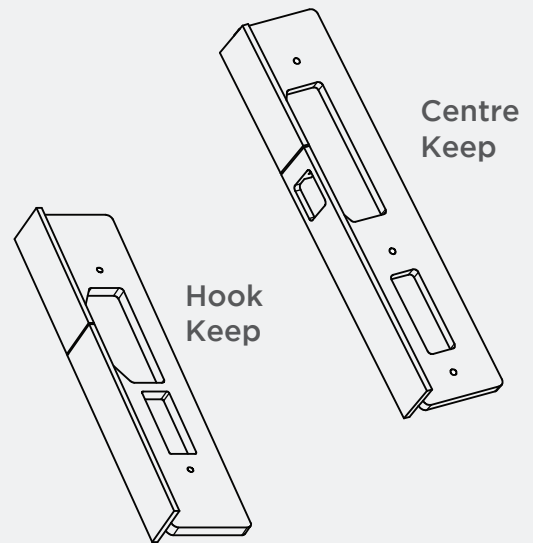
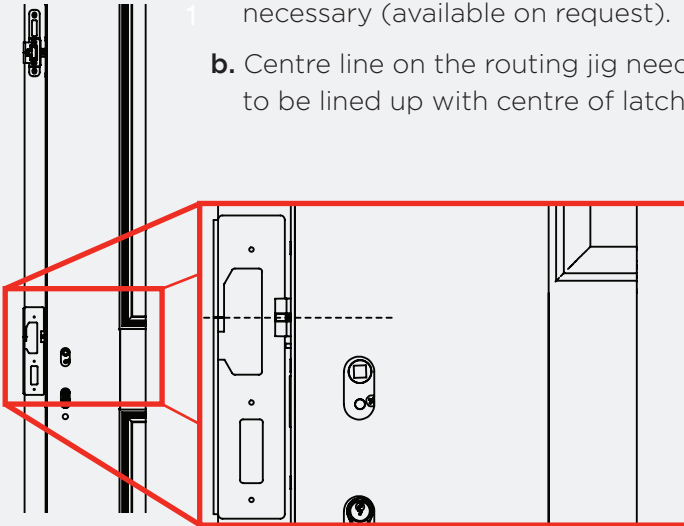

2.

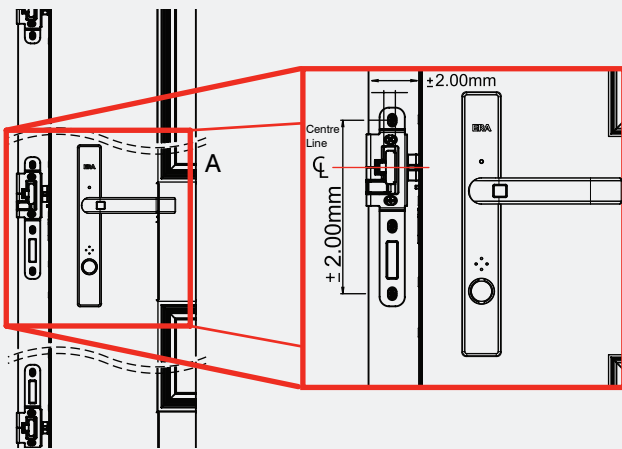

- a. Insert the centre keep into the routed hole and ensure it sits flush to the face of the door frame. It is essential the keep sits flush for stability.
- b. Composite keeps are adjustable +/- 2mm horizontally and vertically, timber keeps are adjustable +/- 2mm horizontally.

3.

Position the keep and fasten to the frame with the appropriate screws for the substrate being used.

4.

Repeat for top and bottom keeps.

5.

Once keeps are fitted, open and close the door to check it is working correctly:

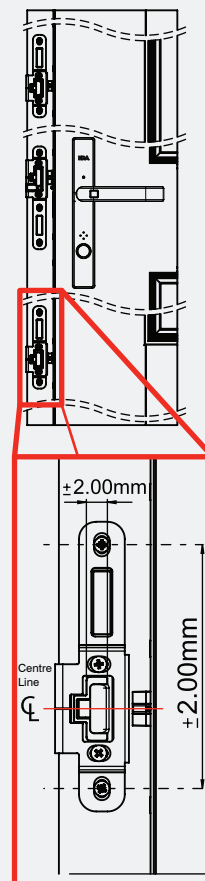

- a. Close door and check the hooks and latches engage fully within top, centre and bottom keeps.
- b. Ensure the thumbturn or key rotates 360° towards the keep making sure the deadbolt is fully engaged.
- c. Rotate thumbturn, key or handle to ensure all locking points fully retract to allow the door to open.
- d. Look for any sign off resistance during operation which may indicate the fitting is not correct.
- e. In the event of operating resistance you may need to adjust the keeps, refer to 2b
- f. Alternatively, to relieve resistance, the centre keep can be offset to the hook keeps.

Pre-installation checks:

1. Depress trigger to ensure hooks drop fully.
2. Insert cylinder and lock to make sure the deadbolt throws and retracts.
3. Make sure the hooks and latches retract fully with cylinder.

Post installation checks:

1. Check the functions of the lock as above.
2. Make sure that the keeps are in the nominal position with full adjustment if required.
3. Close door and activate the lock. The hooks should fall into the keeps.
4. Make sure the deadbolt works with the cylinder.
5. Undo the deadbolt and retract the hooks and latches to open the door.

1. Check gap between door leaf and frame

With the door in the closed position and standing on the opening side. Check that there is a 3-4mm gap between the edge of the leaf and the edge of the frame. The air gap must be consistent from the top to the bottom of the lock jamb.

Please note: If the gap is greater than 4.00mm the trigger will not meet the ramp on the keep and prevent the door from closing correctly.

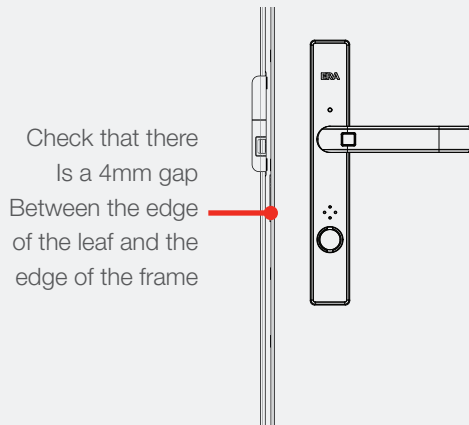

2. Check lock and keep alignment

To check the alignment of the keeps. Open the door slightly and visually check the centre of the latches line up with the centre of the rollers on the keeps, the keeps have a +/- 2.00mm horizontal and vertical adjustment if they require repositioning.

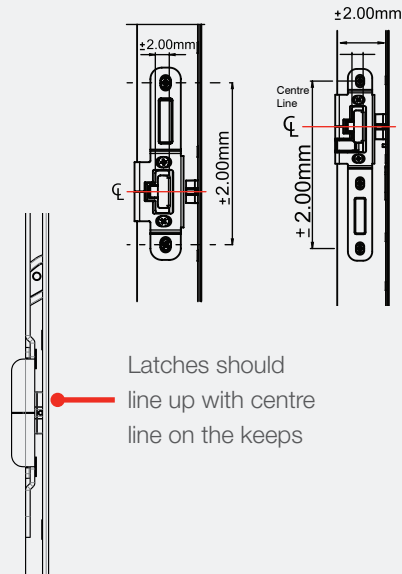

3. Check lock operation

Open the door, depress the steel trigger between the latch and deadbolt in the centre gearbox, both top and bottom hooks and centre deadbolt will be thrown into the locked position. To retract the deadbolt and hooks rotate the thumbturn cylinder away from the lock jamb.

If the lock operates with the door open but has a stiff key operation with the door closed this may indicate that the centre and hook keeps require adjusting (see item 2).

If the lock has a stiff key operation with the door open this, this may indicate a problem with the lock or cylinder. If this is the case, please refer to the trouble shooting guide.

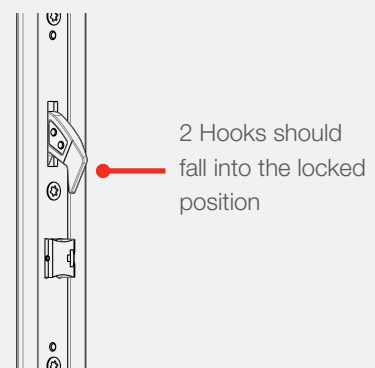
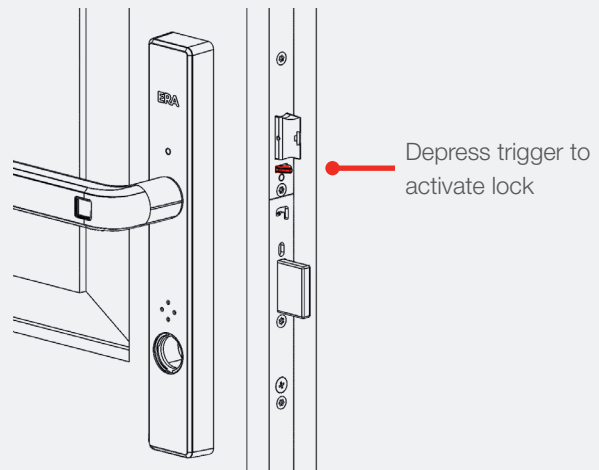

1.

Setting the latch operation

In order to ensure that the door latches correctly, it is important to temporarily disable the hooks. To do this, please use a piece of tape placed over the hooks aperture on the face bar, to hold them into the retracted position. It is also important that compression of the gaskets is achieved on the latches only. The hooks and deadbolt are security measures and should operate "in fresh air".

With the hooks disabled, please close the door until it latches. Check that the leaf is flush with the frame on the opening side of the door. If you need to adjust the keep for compression, then open the door and adjust the roller plates on the centre keep first by undoing the adjustment screws and moving the plates until you achieve a smooth latching operation. Repeat the process on the top and bottom hook keeps until the desired compression is achieved.

Please note: Contact of the hooks with the keeps will result in increased operating forces and therefore, a stiff key operation.

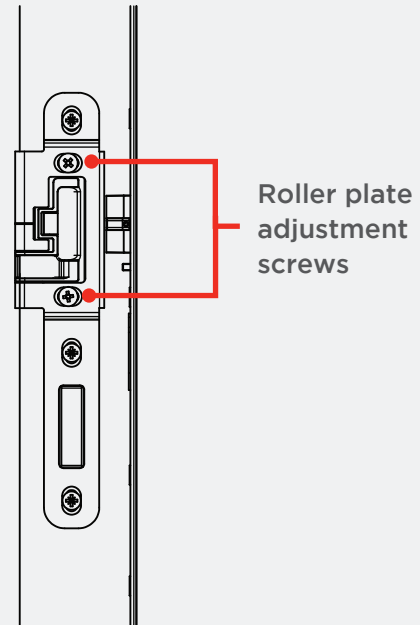

2.

Check hook operation

As stated, the latches are the compression points and when the trigger is depressed and the hooks drop, the hooks should not come into contact with the keeps. Please ensure that the door is fully closed, to check that the hooks are correctly fully engaged. However, it is important that the door is pushed or pulled fully closed to check the hooks are fully engaging.

Remove the tape temporarily holding the hooks. Close the door until it latches and fires the hooks and centre deadbolt. Unlock the door by rotating the thumbturn cylinder away from the lock jamb.

SYMPTOM	POSSIBLE CAUSE	SUGGESTED REMEDY
Hooks not firing when door is shut	Air gap between frame and sash too wide (lock trigger not hitting the keep ramp)	Adjust the hinges or frame fixings to give a 4mm air gap between the sash and frame
Stiff key operation	Door not latched correctly	Relieve pressure on latches by gently pushing or pulling the door closed
	Incorrectly adjusted keeps	The latches are the compression points. Adjust the keeps as necessary
	Too much compression on hinges	Adjust hinges to release compression from frame
	Incorrect positioned keeps	Check keep alignment as detailed in the installation guide
	Air gap between sash and frame too wide	Adjust the hinges or frame fixings to give an optimum 4mm air gap between the sash and frame
	Cylinder incorrectly installed	Remove the handle and check if the lock functions with the cylinder in place. If the lock functions without the handle, then the handle may be twisting the cylinder. Refit the handle taking care not to twist the cylinder.
	Cylinder malfunctioning	Remove cylinder from lock and check operation. Discard and replace cylinder if it malfunctions. Check lock operation using an alternative cylinder. If lock still doesn't operate remove lock from door and check lock independently.
	Lock drive bars cannot operate in router groove	Remove lock from door and check independently. Locate the cause of resistance and rectify by removing material